

## STEP 2: BRAINSTORM POSSIBLE SOLUTIONS



### Learning Target

I CAN use and follow the engineering design and build a Toothpick Bridge that will support the most weight.

**Brainstorm** by communicating your designs through sketching. This process helps engineers to develop different solution ideas. Review the two truss design ideas provided below. In the remaining spaces, sketch 4 different truss design that could be possible solutions.

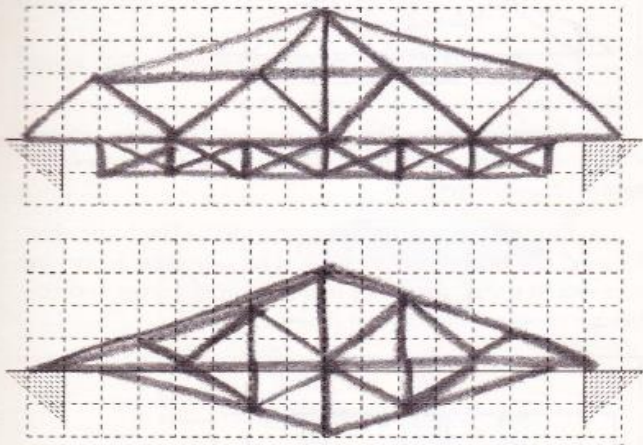

Hand-drawn sketches of bridge designs on grid paper

### IDEA #2

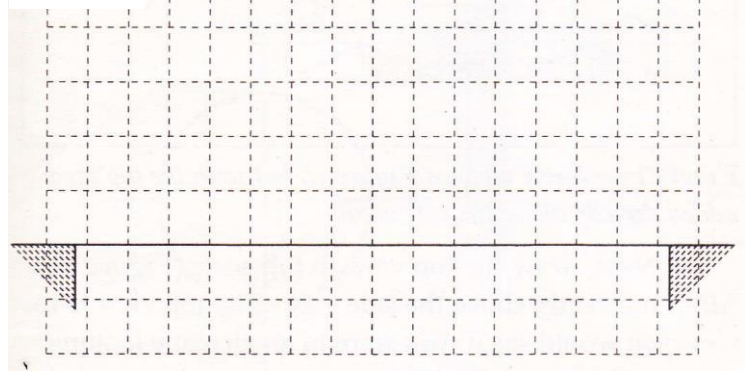

### IDEA #3

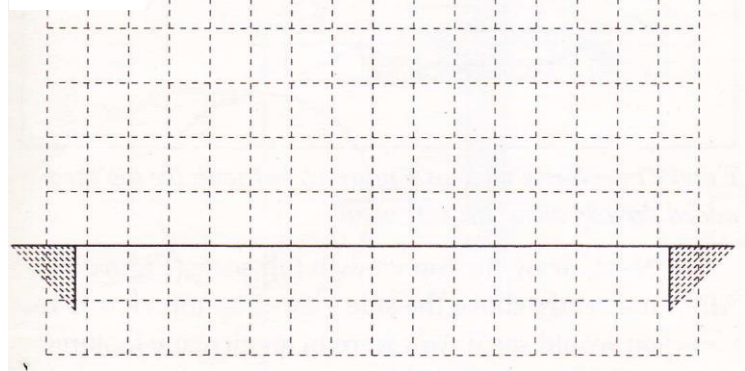

### IDEA #1

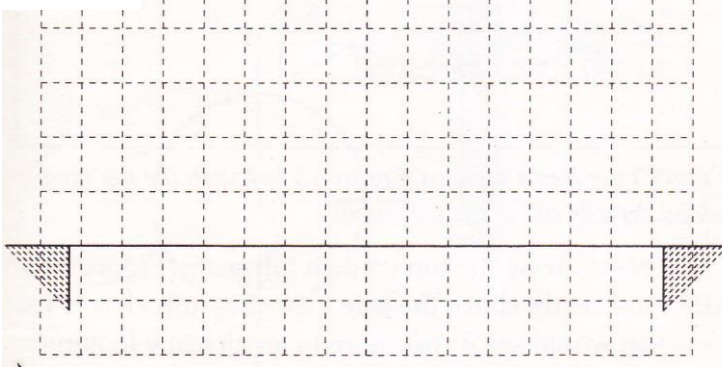

### IDEA #4

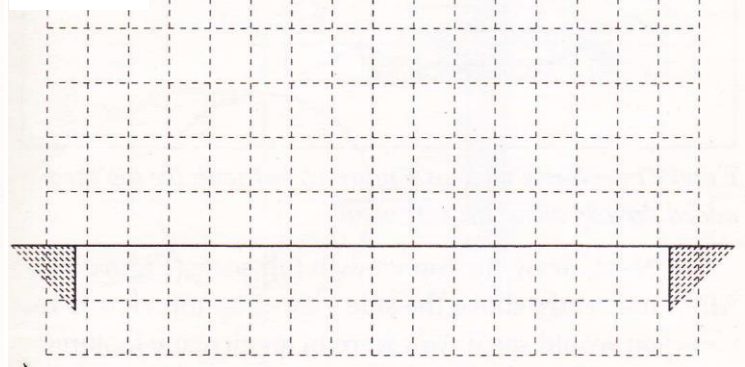

## CHOOSE THE BEST SOLUTION



After analyzing the advantages and disadvantages of possible solutions, I have chosen  
**IDEA #** \_\_\_\_\_ as the best possible solution for the following reasons:

1. \_\_\_\_\_
2. \_\_\_\_\_
3. \_\_\_\_\_